

PORTABLE HONING KIT

model: **KIT410-MP60**

model: **KIT440-MP (*)**



FOR KART ENGINES of **60cc**, 100cc and 125cc with **CAST-IRON** and/or **NICKELED CYLINDERS**

Practical portable kit, that includes all you need to hone kart engine of 60, 100 and 125cc with cast-iron and/or nickel-plated cylinders. The honing kit for cast iron cylinders, is composed by:

- 1x Plastic suitcase with shelf
- 1x Hone with manual expansion (◇)
- 1x Stone Set for Medium Finishing (100 mm length)
- 1x Stone Set for Finishing (100 mm length)
- 1x Cast Iron Truing sleeve (●)
- 1x Container with 500 ml of Oil for Honing
- 1x Technical Documents

- (◇) code **CORRECT-410M** – size Ø 41,5–51 mm for 60cc
- (◇) code **CORRECT-440M** – size Ø 44,0–66 mm for 100 and 125cc
- (●) hole = Ø 42 mm for 60cc
- (●) hole = Ø 50 mm for 100cc
- (●) hole = Ø 54 mm for 125cc

→ **CAST-IRON:** to order, use the following codes:

- (*) code **KIT410-MP60** for engines of 60cc
- (*) code **KIT440-MP100** for engines of 100cc
- (*) code **KIT440-MP125** for engines of 125cc

Unlike cast-iron kit, the honing kit for nickel-plated cylinders, includes the following abrasives:

- 1x Stone Set for Medium Finishing (100 mm length)
- 1x Stone Set of **Diamond** Stones for Finishing (100mm length)

→ **NICKEL:** to order, add the letter "N" before the capacity:

- (*) code **KIT410-MPN60** for 60cc engines, **KIT440-MPN100** for 100cc or code **KIT440-MPN125** for 125cc engines



Photo Gallery:

Suitcase



Diamond set NN18-D330
Nickel-plated Cylinders Finishing



Hone Body



Working example



Dimensions, weights and technical characteristics can be modified without notice.



EFFECIEMME s.n.c. di Cereda M. & C.
 Via dell'Artigianato, 22 – 20881 BERNAREGGIO (MB) ITALIA
 tel.: +39 039 6902705 - fax: +39 039 6902932
 e-mail: effeciemme@effeciemme.com
 web site: www.effeciemme.com

DEALER:

SPARE PARTS PORTABLE HONING KIT

- **60cc:** PORTABLE MANDREL "CORRECT-410M" CAPACITY' Ø 41,5 – 51,0 mm
 → **100 e 125cc:** PORTABLE MANDREL "CORRECT-440M" CAPACITY' Ø 44,0 – 66,0 mm

REF.	410M	440M	CODE	DESCRIPTION
1	✓		C41100M	HONE BODY CPL OF TENSION BAR
		✓	C44100M	HONE BODY CPL OF TENSION BAR
2	✓		C4170X	HONE BODY
		✓	C4470X	HONE BODY
3	✓	✓	C4485X	TENSION BAR
4	✓	✓	C4210M	CONTROL WEDGE (L=225mm)
5	✓		C4145M	UNIVERSAL JOINT CPL 2 SCREW
		✓	C4445M	UNIVERSAL JOINT CPL 2 SCREW
6	✓	✓	C4458M	EXPANDER
7	✓	✓	C4459M	SPRING

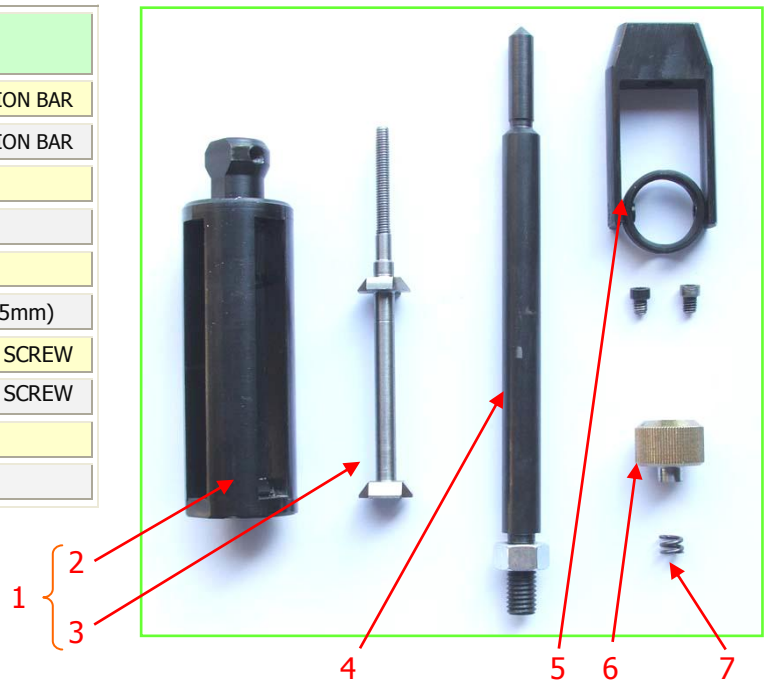

→ **STONE SETS for CAST-IRON CYLINDERS**

> SIZE Ø 41,5 – 51,0 mm - 60cc

- 8) NN17-J528 Medium Finishing
 9) NN17-J540 Finishing

→ **STONE SETS for CAST-IRON CYLINDERS**

> SIZE Ø 49,0 – 56,0 mm – 100cc and 125cc

- 8) NN18-J528 Medium Finishing
 9) NN18-J540 Finishing

→ **STONE SETS for NIKELED CYLINDERS**

> SIZE Ø 41,5 – 51,0 mm - 60cc

- 10) NN17-D330 Diamond Stone Set for Finishing

> SIZE Ø 49,0 – 56,0 mm – 100cc e 125cc

- 10) NN18-D330 Diamond Stone Set for Finishing



8



9

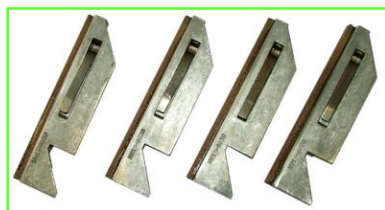

10



11



12

→ **ITEMS TO COMPLETE THE KIT**

- 11) SPB440 Suitcase Plastic Bag
 12) SC04.500ML 500 ml Bottle of Honing Oil
 13) BA-42M Cast Iron Truing Sleeve for 60cc
 13) BA-50M Cast Iron Truing Sleeve for 100cc
 13) BA-54M Cast Iron Truing Sleeve for 125cc



13

